



SmartBright LED Floodlight

BVP171 LED26/CW 30W WB GREY CE

LED module 2600 lm

The SmartBright LED Floodlight is a versatile floodlight engineered to deliver significant energy savings, an ideal solution for diverse floodlighting applications. The product is also designed to meet relevant performance and safety standards, offering you reliable and long-lasting performance.

Product data

| General Information | |
|--|---|
| Lamp family code | LED26 [LED module 2600 lm] |
| Light source color | 757 cool white |
| Light source replaceable | No |
| Driver included | Yes |
| Optical cover/lens type | Polycarbonate bowl/cover UV-resistant |
| Luminaire light beam spread | 30° x 80° |
| Control interface | - |
| Connection | Flying leads/wires |
| Cable | Cable 0.6 m without plug |
| Protection class IEC | Safety class I |
| Flammability mark | For mounting on normally flammable surfaces |
| CE mark | CE mark |
| Constant light output | No |
| Number of products on MCB of 16 A type B | 60 |
| Light source engine type | LED |

| Operating and Electrical | |
|-----------------------------|-----------------------------|
| Input Voltage | 220 to 240 V |
| Input Frequency | 50 or 60 Hz |
| Inrush current | 1.18 A |
| Inrush time | 0.0033 ms |
| Power Factor (Min) | 0.9 |
| Controls and Dimming | |
| Dimmable | No |
| Mechanical and Housing | |
| Housing Material | Aluminum die cast |
| Optical cover/lens material | Polycarbonate |
| Mounting device | Mounting bracket adjustable |
| Optical cover/lens shape | Flat |
| Optical cover/lens finish | Frosted |
| Overall length | 195 mm |
| Overall width | 143 mm |

SmartBright LED Floodlight

| | |
|--------------------------|----------------------|
| Overall height | 34 mm |
| Effective projected area | 0.027 m ² |
| Color | Gray |

Approval and Application

| | |
|--|---|
| Ingress protection code | IP65 [Dust penetration-protected, jet-proof] |
| Mech. impact protection code | IK07 [2 J reinforced] |
| Surge Protection (Common/Differential) | 4/2 kV |

Initial Performance (IEC Compliant)

| | |
|-------------------------------------|---------|
| Initial luminous flux (system flux) | 2600 lm |
| Luminous flux tolerance | +/-10% |
| Initial LED luminaire efficacy | 86 lm/W |
| Init. Corr. Color Temperature | 5700 K |
| Init. Color Rendering Index | >70 |
| Initial chromaticity | SDCM<7 |
| Initial input power | 30 W |

| | |
|-----------------------------|--------|
| Power consumption tolerance | +/-10% |
|-----------------------------|--------|

Application Conditions

| | |
|---------------------------|----------------|
| Ambient temperature range | -40 to +45 °C |
| Maximum dim level | Not applicable |

Product Data

| | |
|---------------------------------|--------------------------------|
| Full product code | 871016332077999 |
| Order product name | BVP171 LED26/CW 30W WB GREY CE |
| EAN/UPC - Product | 8710163320779 |
| Order code | 911401673104 |
| Numerator - Quantity Per Pack | 1 |
| Numerator - Packs per outer box | 16 |
| Material Nr. (12NC) | 911401673104 |
| Net Weight (Piece) | 0.600 kg |



Dimensional drawing

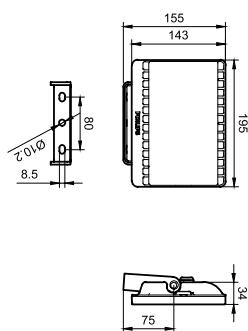

BVP171/172

